

F:\Project\858 - ERIE INTERNATIONAL AIRPORT\858014005-WO 10\CADD\Sheet Files\hammerhead cul-de-sac exhibit.dgn

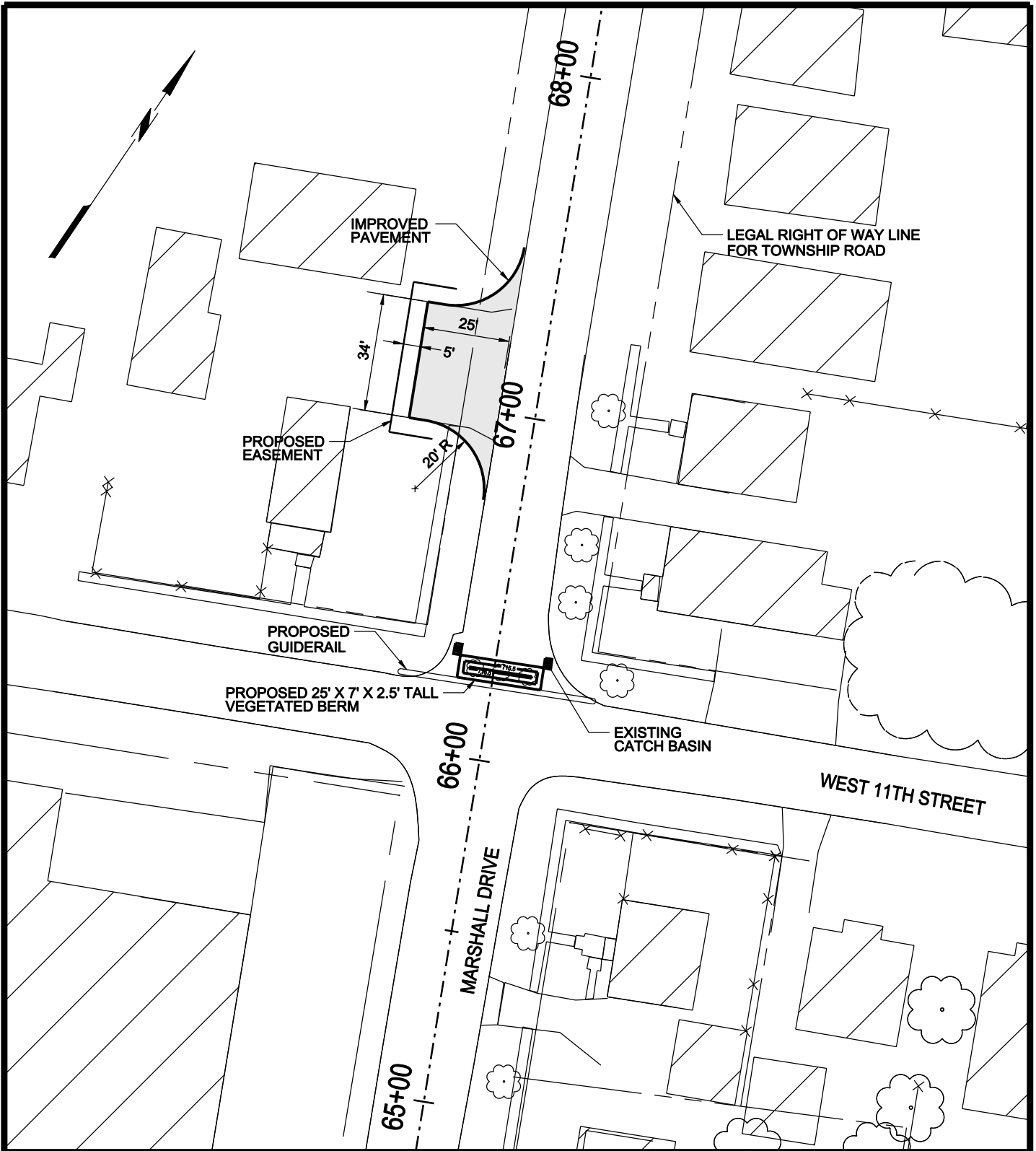

TITLE:

MARSHALL DRIVE TURNAROUND EXHIBIT

C&S Engineers, Inc.
 499 Col. Eileen Collins Blvd.
 Syracuse, New York 13212
 Phone: 315-455-2000
 Fax: 315-455-9667
 www.cscos.com



DATE: FEBRUARY 4, 2010

SCALE: 1" = 40'

FILE NO. 858014005

SHEET NO.

1 OF 1

Copyright ©